

## DESCRIPTION

Once the connections are made as in the drawing, the control unit is already operational via wire with the pre-set functions and default settings.

## USE VIA WIRE

The function of the keys is pre-set.

Button 1:

short press= On Off

long press= dimmer up/down

Button 2:

short press= Change of colour

long press= Memo colour

Button 3:

short press= Play / stop cycle

long press= Change cycle speed

## DEFAULT PARAMETERS

The control unit has pre-set parameters for standard operation.

- load connected: rgb
- memo function: disabled
- fade on: 0,5s
- fade off: 0,5s
- timer: none

These settings can be customised, see the full manual.

## USE VIA RADIO

To be able to use a transmitter an association must first be made, see procedure on the back

# RADIO PROGRAMMING

This procedure lets you programme compatible multifunctional or generic transmitters.

## WHICH REMOTE CONTROL DO YOU WANT TO ASSOCIATE WITH THE CONTROL UNIT?

### MULTIFUNCTIONAL TRANSMITTERS - MODELS AND CODES



**CODE:**  
HB70-1L



**CODE:**  
HB80-30D,  
HB80-2L  
HB80-4L,  
HB80-4RGBW,  
HB80-30RGBW



**CODE:**  
HB90-6LT  
HB90-6DM  
HB90-8P

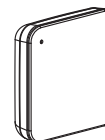

**CODE:**  
TOUCH-1L  
TOUCH-1  
TOUCH-1CCT

With multifunctional transmitters the transmitter control modes depend on the model used. Refer to the transmitter manual, to the paragraph entitled "commands sent by the transmitter", bearing in mind that it is an "RGBW" device.

### GENERIC TRANSMITTERS - MODELS AND CODES



**CODE:**  
HB70-5G

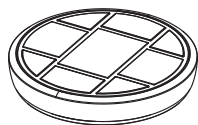

**CODE:**  
HB80-6G



**CODE:**  
MCU-TX4



**CODE:**  
TOUCH-1G  
TOUCH-2G  
TOUCH-4G

With generic transmitters, the transmitter's control modes depend on the function associated with the key during the association procedure.

The available function for the key are:

**TABELLA 4.1 - KEY FUNCTIONS OF THE GENERIC TRANSMITTER**

NUMBER TO BE SET IN "STEP 3b" OF THE PROCEDURE	KEY FUNCTION
2	<b>Short press:</b> ON/OFF <b>Prolonged press:</b> Dimmer intensity UP / DOWN
3	ON
4	OFF
5	Dimmer intensity UP
6	Dimmer intensity DOWN
7	<b>Short press:</b> with light on it changes colour <b>Prolonged press:</b> with light off dimmer colour / with light on save colour (see paragraph 5.1)
8	Dimmer intensity UP shade of colour
9	Dimmer intensity DOWN shade of colour
10	Play / stop "colour cycle" (see paragraph 5.4)
11	Change effect of "colour cycle" (see paragraph 5.4)
12	Change duration of "colour cycle" (see paragraph 5.4)
13	Deactivate "save colour" (see paragraph 5.1) "Soft Off 1h":
14	"Soft Off 1 hr": gradual fading in one hour (see paragraph 5.2)

## PROCEDURE

### STEP 1

Short presses on the "SET" key let you scroll through the menu until "P1" programming appears on the display.

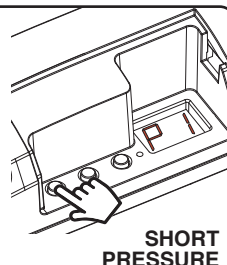

### STEP 2

A prolonged press on the "SET" key (approx. 3 seconds) takes you into programming.

The LED on the receiver comes on

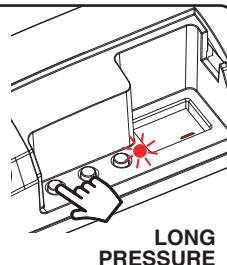

### WHICH TRANSMITTER DO YOU WANT TO PROGRAMME?

**MULTIFUNCTION TRANSMITTER**  
(see models and codes on previous page)

**GENERIC TRANSMITTER**  
(see models and codes on previous page)

### STEP 3a

Short presses on key "B" let you set value "1" on the display

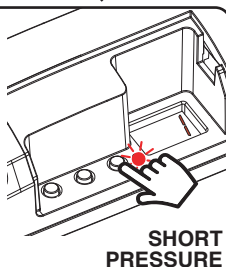

### STEP 3b

Short presses on key "B" let you choose the function you want to programme shown on the displays. See table 4.1 on the previous page.

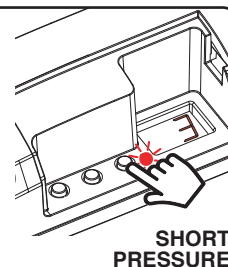

### STEP 4

Give a long press on key "B" (approx. 3 seconds).

The LED on the display comes on

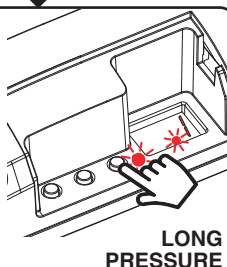

### STEP 5

Make a transmission with the transmitter to be saved (see transmitter manual, the paragraph entitled "transmitter programming").

The LED on the receiver flashes 3 times to signal that it has been received.



MAKE A TRANSMISSION WITH THE TRANSMITTER

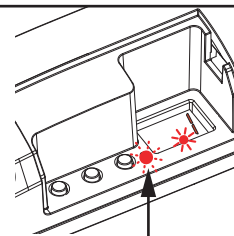

THE LED FLASHES 3 TIMES

### STEP 6

The control unit listens for 50 seconds in case you want to add other transmitters. To immediately exit the procedure give a short press on key "b".

The LED on the display turns off

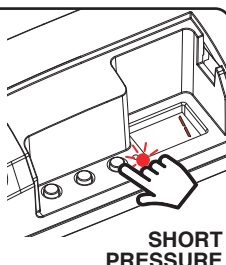

### STEP 7

The control unit goes back to the menu displaying the radio programming. If you want to save other transmitters, go back to point 3 of this procedure.

If you want to go back to the menu displaying the different types of programming, give a prolonged press to the "SET" key (approx. 3 seconds).

# Quick start TOP-V8/RGBW

*Control unit for RGB and RGBW strip  
(LEDs with constant voltage)*

## CONNECTION DIAGRAM

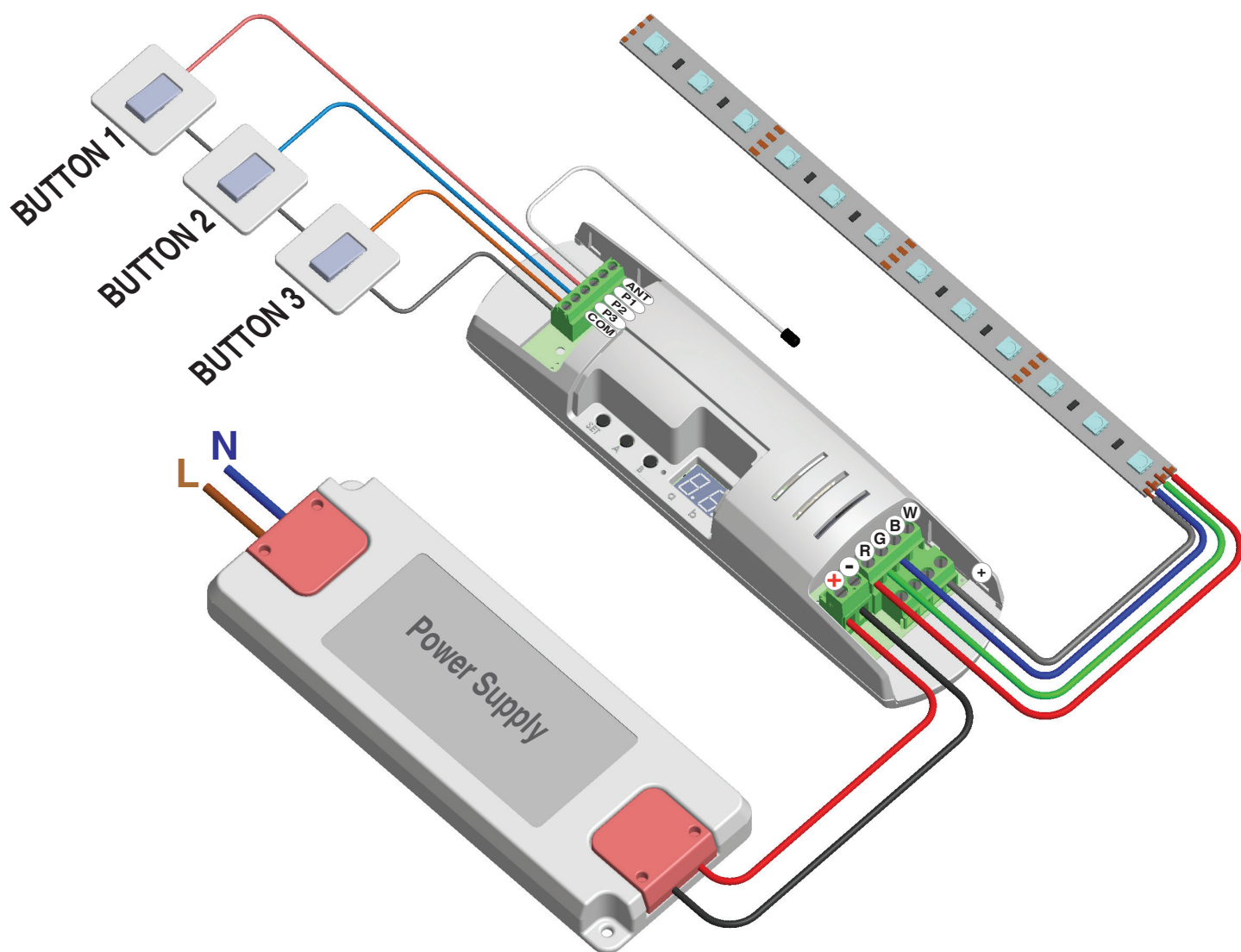

### ATTENTION:

See the full manual for the restrictions on use  
and full features of the control unit